



LOCATION:
KENYA

PARTNERSHIP ESTABLISHED:
2020

TARGET MARKET:
BOTTOM 20-40% OF THE INCOME PYRAMID

PIONEERING 3D PRINTED CLIMATE-SMART MATERIALS LEADING TO HIGH QUALITY AFFORDABLE HOMES

14Trees Kenya are pioneering 3D printing technology for affordable housing in Africa for the first time. 14Trees are aiming to make green affordable housing a reality for Africans, with homes built at record speed and a 70% reduction in the carbon footprint of construction.

WHY WE PARTNERED

Reall partnered with 14Trees Kenya on the basis of their impressive commitment to climate smart housing delivery. 14Trees are named as such because they estimate that their carbon-smart eco-friendly construction can save around 14 trees from being cut down per home built.

14Trees are developing cutting edge 3D printing technology in order to scale and green their offer of affordable homes. This is possible because 3D printing greatly reduces the time and material cost of construction, minimising the carbon footprint of homes by up to 70%. Their 3D printed walls can be constructed in a few hours as opposed to the four days of conventional construction, drastically increasing the speed of delivery, which is carried out by a skilled team of local experts.

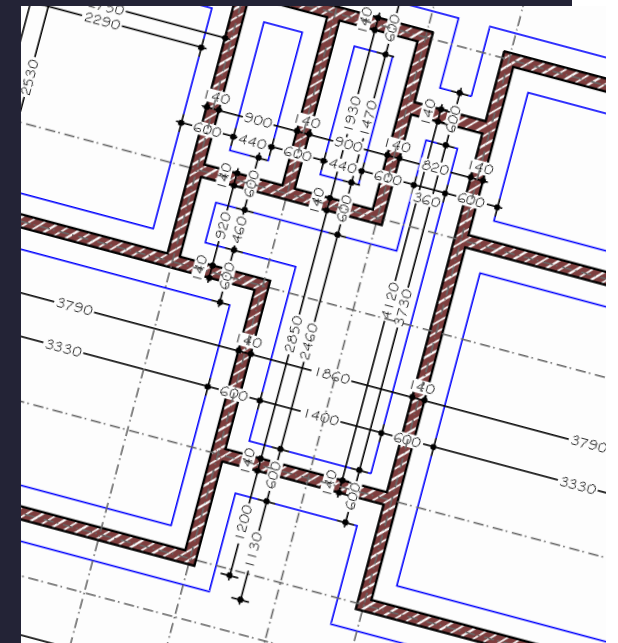

TOGETHER WITH
OUR PARTNERS WE
ARE BUILDING AN
**AFFORDABLE HOMES
MOVEMENT WHICH
WILL TRANSFORM
THE LIVES OF 100M
PEOPLE IN URBAN
AFRICA AND ASIA BY
2030.**

BUILD & BROKER

BUILD: 14Trees Kenya are looking to develop three projects of 50-100 homes over a 12-month period using their innovative aluminium formwork technology.

BROKER: 14Trees Kenya are looking to prove the viability of climate smart and innovative construction technology for the low-income housing bracket in a way that can be scaled and replicated.

ACCOLADES AND ACCREDITATIONS

- Shortlisted for the Reuters Responsible Business Awards 2020 in the Social Impact Category
- Their sister company, 14Trees Malawi, has been endorsed by the United Nations Development Programme for their ecobrick technology

DELIVERY

14Trees Kenya are an innovative start up established based on the track record of their sister company, 14Trees Malawi. Successes in Malawi gives confidence of replication in the Kenyan context, where they have shifted to a different build product following extensive market research.

EMPOWERING LOW INCOME GROUPS

- Innovative construction techniques significantly speed up and reduce the cost of construction, allowing for affordability for people living on low incomes
- 14Trees are collaborating with credit cooperatives and local banks to arrange affordable finance for clients

